

## RSBT

### RSBT DOUBLE SHEAR BEAM LOAD CELLS



Double shear beam load cells particularly suitable for weighing weighbridges, dosage systems, tanks, silos, etc., complete of support and oscillating sphere joint. CE-M approved.

---

CAPACITIES (kg): 25000, 40000.

---

OIML R60. C3 precision class.

---

Nickel-plated steel. IP68 protection.

---

Working in cooperation with:

**SC DATA SPEED SRL**

STR DONATH N. 115/33 - 400331 - JUD. CLUJ  
Tel. 0040-264566473 Fax. 0040-364-815440  
office@cantare.com.ro

The best solution  
for advanced industrial  
applications

## MAIN FEATURES

- C3 PRECISION CLASS;
- EXECUTED IN NICKEL-PLATED STEEL WITH LASER SOLDERINGS;
- HIGH PRECISION AND LINEARITY ALSO WITH NON PERPENDICULAR LOADS;
- OPTIMISED FOR PARALLEL CONNECTION;
- IP68 PROTECTION DEGREE;
- CAPACITY FROM 25000 TO 40000kg;
- SHIELDED TEFLON CONNECTION CABLE;
- TEST CERTIFICATE AVAILABLE UPON REQUEST.

## TECHNICAL FEATURES

- Minimum verification interval:  $V_{min} = E_{Max} / 10.000$ ;
- Maximum number of load cell divisions:  $n_{LC}=3000$  (C3);
- Full Scale Output:  $2mV/V \pm 0,2\%$ ;
- Temperature effect on full scale output:  $0,0014\%FS/^{\circ}C$ ;
- Temperature effect on the zero:  $\pm 0,0017\%FS/^{\circ}C$ ;
- Compensated temperature range:  $-10^{\circ}C/+40^{\circ}C$ ;
- Operating temperature range:  $-35^{\circ}C/+65^{\circ}C$ ;
- Creep error after 30 minutes:  $0,02\%$  F.S.;
- Excitation voltage: from 5 to 18 VDC;
- Input Resistance: 750 Ohm;
- Output Resistance:  $700 \pm 7$  Ohm;
- Zero Balance:  $\pm 1,5\%$  F.S.;
- Insulation resistance  $> 5000$  MOhm;
- Safe overload  $> 150\%$  F.S.;
- Maximum overload  $300\%$  F.S.;
- 4-wire shielded cable, 15m long.

<u>Wiring Code</u>	
<u>Colour</u>	<u>Function</u>
--	SHIELD
GREEN	OUTPUT +
RED	INPUT +
WHITE	OUTPUT -
BLACK	INPUT -

## ATEX VERSION

- The CCATEX certificate makes the load cell suitable for use in hazardous areas with protection methods according to:  
ATEX II 1G Ex ia IIC T6 (Ta  $-20 \div +40^{\circ}C$ ) TX (Ta  $-20 \div +65^{\circ}C$ ) Ga  
ATEX II 1D Ex ta IIIC TX $^{\circ}C$  (Ta  $-20 \div +40^{\circ}C$ ) TX $^{\circ}C$  (Ta  $-20 \div +65^{\circ}C$ ) Da IP65.  
The certificate includes the manual and the ATEX CE conformity declaration (available in EN, DE, FR, and IT).
- IMPORTANT: the certificate refers to the single load cell. For systems with more load cells, it is necessary to order one certificate for each load cell.

## DETAIL 1

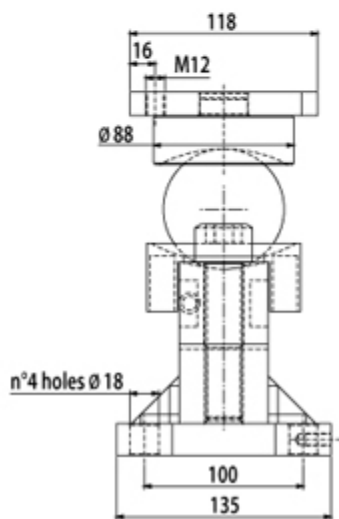
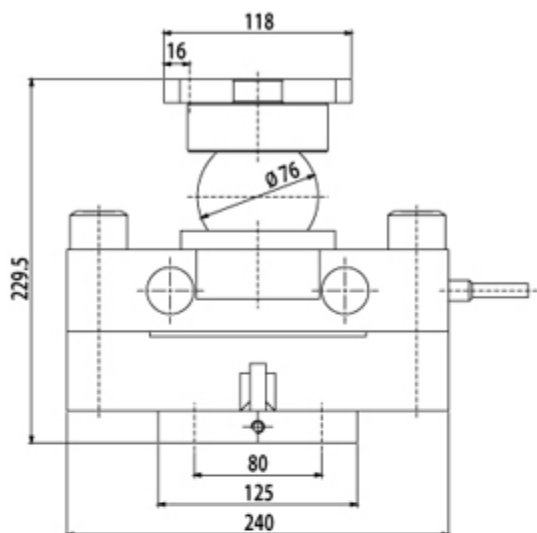

## VERSIONS

### Versioni disponibili

Codice	Max (kg)
RSBT25C3	25000
RSBT40C3	40000



www.diniargeo.com



“YOUR WORLDWIDE PARTNER FOR WEIGHING,”

DINI ARGEO  
FRANCE sarl  
Nogent-sur-Marne

DINI ARGEO  
GMBH  
Sinsheim - Germany

DINI ARGEO  
UK Ltd  
Taunton - United Kingdom

DINI ARGEO WEIGHING  
INSTRUMENTS Ltd  
Shanghai - China

DINI ARGEO  
WEIGHBRIDGES  
Calto (RO) – Italy



HEAD OFFICE  
Via Della Fisica, 20  
41042 Spezzano di Fiorano Modena - Italy



**SC DATA SPEED SRL**

STR DONATH N. 115/33 - 400331 - JUD. CLUJ

Tel. 0040-264566473 Fax. 0040-364-815440

office@cantare.com.ro

SALES AND TECHNICAL ASSISTANCE SERVICE