

# Type H3G Load Cell



## Short description

- Nickel plated alloy steel IP67 "S" type load cell
- Tension and compression applications
- Suitable for hanging, hopper and other weighing devices
- Also available in imperial capacities and dimensions



 test certificate no. TC7866 Revision 0  
C of C no R60/2000-CNI-00.01

 Certificate no. 06-099A1

## Available models

	Accuracy	Full article description
50kg	C3	H3G-C3-50kg-6B
100kg	C3	H3G-C3-100kg-6B
250kg	C3	H3G-C3-250kg-6B
500kg	C3 Excluded from OIML	H3G-C3-500kg-6B
1t	C3 Excluded from OIML	H3G-C3-1t-6B
2.5t	C3 Excluded from OIML	H3G-C3-2.5t-6B
5t	C3 Excluded from OIML	H3G-C3-5t-6B
7.5t	C3 Excluded from OIML	H3G-C3-7.5t-6B

Specifications and dimensions are subject to change without notice and do not constitute any liability whatsoever.

# Type H3G Load Cell

## Detailed specifications H3G

Accuracy class		OIML R60 C3	C3
Output sensitivity ( = FS )	mV/V	3.0 ± 0.008	
Maximum capacity ( E <sub>max</sub> )	t	0.05, 0.1, 0.25	0.5, 1, 2.5, 5, 7.5
Max.number of load cell intervals	n <sub>LC</sub>	3000	
Ratio of min. LC verification interval	$Y = E_{max} / v_{min}$	15000	14000
Combined Error	%FS	≤± 0.020	
Minimum dead load	Of E <sub>max</sub>	0%	
Safe overload	of E <sub>max</sub>	150 %	
Ultimate overload	of E <sub>max</sub>	300 %	
Zero balance	of FS	< ± 1.0 %	
Excitation, recommended voltage	V	5 ~ 12	
Excitation maximum	V	18	
Input resistance	Ω	430 ± 60	
Output resistance	Ω	351 ± 2.0	
Insulation resistance	MΩ	≥5000 ( at 50VDC )	
Compensated temperature	°C	-10 ~ +40	
Operating temperature	°C	-35 ~ +65	
Storage temperature	°C	-40 ~ +70	
Element material		Nickel plated alloy steel	
Ingress Protection (acc. to EN 60529)		IP67	
Recommended torque on fixation	Nm	M8:25	M12:75 M20:450 M24:750
ATEX classification (optional)		II1G Ex ia II1C T4	II1D Ex iaD 20 T73°C II3G nL IIC T4

## Wiring

### Wiring:

Shielded, 4 conductor cable.

Cable diameter: Ø5mm.

Standard cable length: 6m.

Shield not connected to element.

### 4-wire diagram

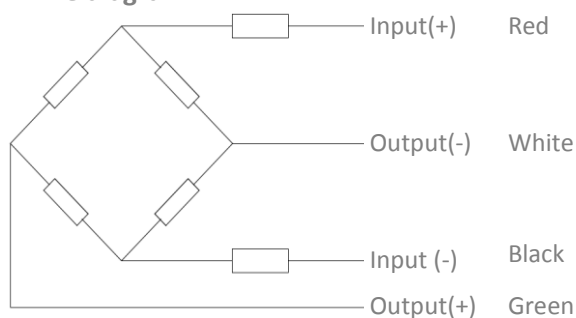

Specifications and dimensions are subject to change without notice and do not constitute any liability whatsoever.

# Type H3G Load Cell

Dimensions in mm

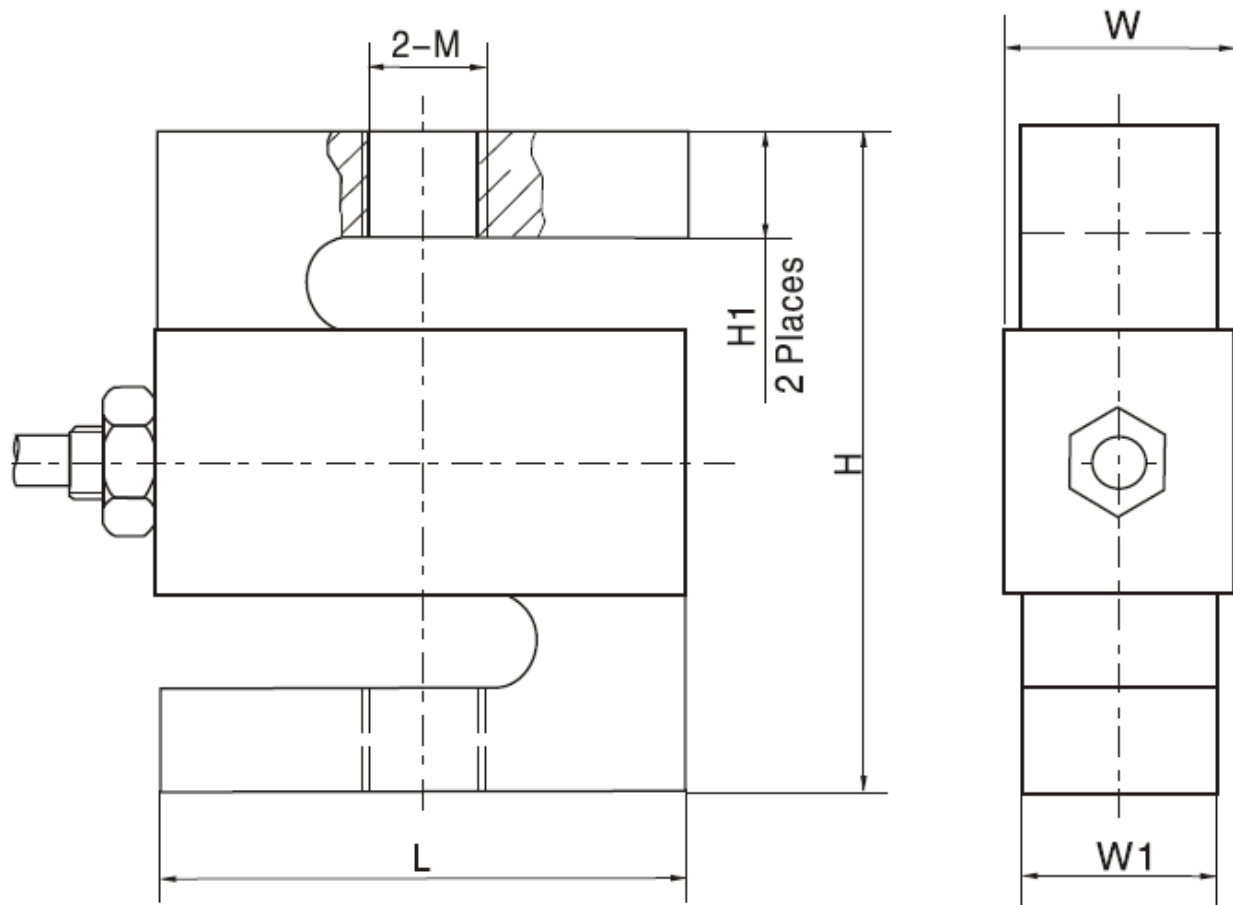

Dimension Capacity	L	H	H1	W1	W	H1	M
50-100kg	50.8	63.5	10.16	12.7	16.5	10.2	M8 x 1.25
250-500kg	50.8	63.5	10.16	19.05	22.8	10.2	M12 x 1.75
1t	50.8	63.5	10.16	25.4	29.2	10.2	M12 x 1.75
2.5t	76.2	101.6	15.2	25.4	29.2	15.2	M20 x 1.5
5t	76.2	101.6	20	25.4	29.2	20	M20 x 1.5
7.5t	101.6	139.7	30	31.75	35.5	31	M24 x 2

Specifications and dimensions are subject to change without notice and do not constitute any liability whatsoever.

# Type H3G Load Cell

## Available accessories

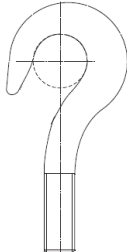
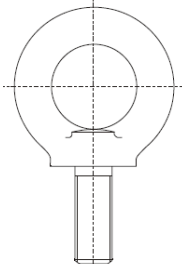
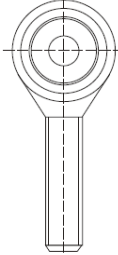
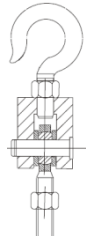
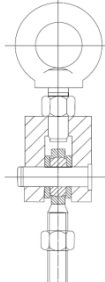
<p><b>HL-3-001-25kg-5t hook</b></p> <ul style="list-style-type: none"><li>• Alloy Steel</li><li>• Suitable for hybrid scales, crane scales, packaging scales and hopper scales</li></ul>	
<p><b>HL-3-002-25kg-5t eye</b></p> <ul style="list-style-type: none"><li>• Alloy Steel</li><li>• Suitable for hybrid scales, crane scales, packaging scales and hopper scales</li></ul>	
<p><b>HL-3-003-25kg-5t rod end</b></p> <ul style="list-style-type: none"><li>• Alloy Steel</li><li>• Suitable for hybrid scales, crane scales, packaging scales, hopper scales and other electronic weighing devices.</li></ul>	
<p><b>HL-3-004-25kg-5t hook assembly</b></p> <ul style="list-style-type: none"><li>• Alloy Steel</li><li>• Suitable for hybrid scales, crane scales, packaging scales, hopper scales and other electronic weighing devices.</li></ul>	
<p><b>HL-3-005-25kg-5t eye assembly</b></p> <ul style="list-style-type: none"><li>• Alloy Steel</li><li>• Suitable for hybrid scales, crane scales, packaging scales, hopper scales and other electronic weighing devices.</li></ul>	

Specifications and dimensions are subject to change without notice and do not constitute any liability whatsoever.