

## PLX1K

### PLX1K SERIES' CELL KITS FOR ASSEMBLING FLOOR SCALES



Ideal for creating platforms with four load cells of various sizes and capacities, connectable to any type of weight indicator. The kit is made up of four "SBX-1K" IP68 STAINLESS STEEL load cells, CE-M approved, together with hypersanitizable adjustable resting feet and an IP67 ABS junction box with a built-in equalisation board.

Working in cooperation with:

**SC DATA SPEED SRL**

STR DONATH N. 115/33 - 400331 - JUD. CLUJ  
Tel. 0040-264566473 Fax. 0040-364-815440  
office@cantare.com.ro

The best solution  
for advanced industrial  
applications

## MAIN FEATURES

- Load cells:
  - C3 precision class
  - Made in 17-4 PH STAINLESS STEEL with laser welding
  - IP68 protection against dust and water.
  - Capacities from 500 to 2000 kg (for each cell)
- Resting feet adjustable in height:
  - Structure in STAINLESS steel
  - Anti-slip rubber
  - Ipsanitizable
- Junction box:
  - Built-in junction and equalisation board
  - IP67 protection from dust and water
  - 5 Fairleads

## LOAD CELL TECHNICAL FEATURES

- Minimum load cell verification interval:  $V_{min} = E_{Max} / 10.000$
- Maximum number of verification intervals:  $n_{LC} = 3000$
- Combined error: 0,017% of Full Scale Output (F.S.)
- Full Scale Output: 2mV/V +/- 0.5%
- Temperature effect on zero: 0,002% /°C
- Temperature effect on full scale output: 0,002% /°C
- Compensated Temperature Range: -10°C/+50°C
- Operating Temperature Range: -20°C/+60°C
- Creep error after 30 minutes: 0,02% F.S.
- Maximum tolerated excitation voltage: 15 Vdc
- Input Resistance:  $1100 \pm 20 \text{ Ohm}$
- Output Resistance:  $1000 \pm 20 \text{ Ohm}$
- Insulation Resistance: >5000 MOhm
- Safe Overload: 150% F.S.
- Ultimate Overload: 300% F.S.
- 6-wire shielded cable, 5m long, 5 mm diameter

## EXTRAS AVAILABLE AT TIME OF ORDER

- Test certificate (available upon request)
- WELMEC module for approval of the system for PLX kit (connected to Dini Argeo indicator)
- ATEX Certification (CCATEX OPTION)

## DIMENSIONS - STANDARD CABLE DECODING

- Dimensions in mm:

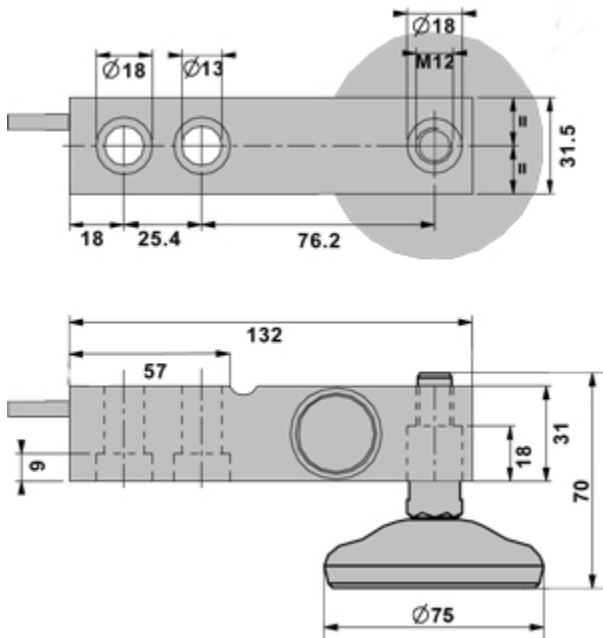

- Decoding of the standard cable colours:

Colour	Function
--	SHIELD
YELLOW	OUTPUT +
GREY	SENSE +
BROWN	POWER SUPPLY +
WHITE	OUTPUT -
GREEN	POWER SUPPLY -
PINK	SENSE -



www.diniargeo.com



“YOUR WORLDWIDE PARTNER FOR WEIGHING,”

DINI ARGEO  
FRANCE sarl  
Nogent-sur-Marne

DINI ARGEO  
GMBH  
Sinsheim - Germany

DINI ARGEO  
UK Ltd  
Taunton - United Kingdom

DINI ARGEO WEIGHING  
INSTRUMENTS Ltd  
Shanghai - China

DINI ARGEO  
WEIGHBRIDGES  
Calto (RO) – Italy



HEAD OFFICE  
Via Della Fisica, 20  
41042 Spezzano di Fiorano Modena - Italy



**SC DATA SPEED SRL**

STR DONATH N. 115/33 - 400331 - JUD. CLUJ

Tel. 0040-264566473 Fax. 0040-364-815440

office@cantare.com.ro

SALES AND TECHNICAL ASSISTANCE SERVICE